

PRESA DI FORZA A COMANDO PNEUMATICO

PNEUMATIC CLUTCH POWER TAKE-OFF

CODICE PTO
PTO CODE

60-25-10137

CAMBIO
GEARBOX

FAW-JAC

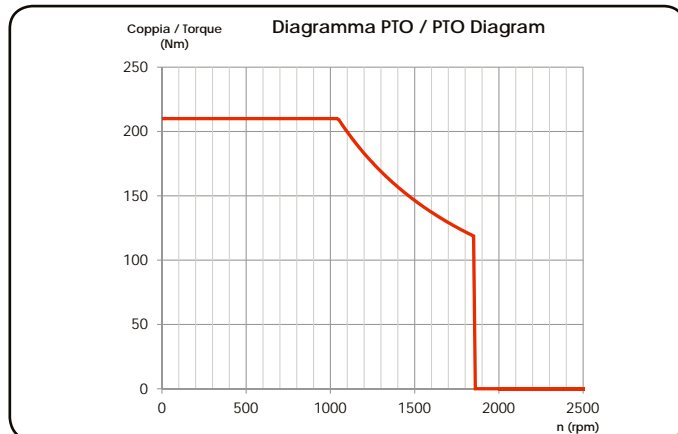

Interruttore segnalazione PTO inserita / PTO pressure signal switch

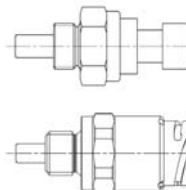

PACKARD
311-001-00116

OPTIONAL
Da ordinare
separatamente
To be ordered
separately

DIN 72585
311-001-00205

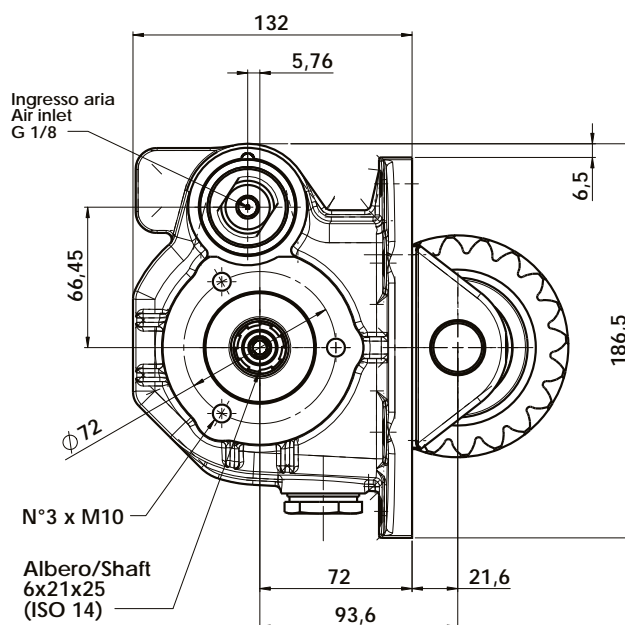
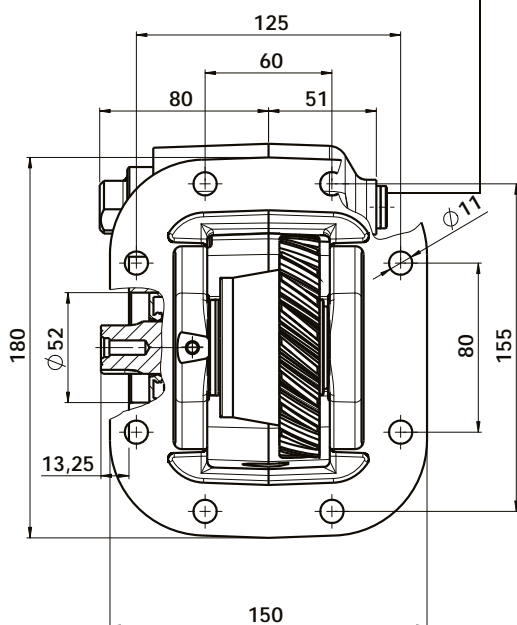

Tipo cambio Gearbox	Codice PTO PTO code	Versione Version	Giri pto a 1000 giri motore Pto ratio@1000 eng.rpm	Coppia massima Max torque	Lato montaggio Mounting side	Uscita Output	Rotazione Rotation	Kit di montaggio Mounting kit	Peso Weight
CA-6T 138 BX045M BX075M BX085M BX090M	60-25-10137	13	Vedi indice See index	210	Sx Left	Post. Rear	Ora. Cw	154-3-3311	11,7

Data: Lunedì 23 maggio 2016

Codice foglio: 997-260-02514 Rev: //

Binotto®

THE TIPPING POWER

pag.1

Binotto srl

We reserve the right to make any changes without notice.
Edition 2014.07 No reproduction, however partial, is permitted.
Via Divisione Julia 7/B 36010 Dueville (Vicenza) Italy Tel.: +39 0444593290
Fax: +39 0444593357 Internet: www.binotto.com e-mail: info@binotto.com